



Our Rooms

Guest Rooms

Unwind in our stylish Guest Rooms with contemporary and modern amenities. Our Single, Double and Twin Rooms feature an enviable standard of décor and comfort.

Superior and Deluxe Superior Rooms

Choose our stylish and spacious Queen Superior Rooms if you are looking for extra space. Perfect for small families, our Family Queen Superior Rooms feature one double bed and a sofa bed to accommodate a third person. Our new Deluxe Superior Rooms boast comfortable king or queen beds with extra amenities and contemporary décor.

Premium and Deluxe Premium Rooms

For the ultimate in luxury, upgrade to our spacious King Premium Rooms or seek out exclusivity with our new Deluxe Premium Rooms. Located in the premium wing of our hotel, these rooms feature high ceilings and upgraded amenities.

Suites

Experience total indulgence with high quality furnishings and modern conveniences in our new Junior Suites or our stylish King Junior Suites featuring a separate living area with sofa bed.

Our Facilities

Fitness Centre

Re-charge in our state-of-the-art fitness centre where guests can keep up to date with their fitness routine in our fully equipped gym.

Business centre

All your business requirements can be met here, whether you are here on business or just need to check into the office. Complimentary WiFi, printing and copying are some of the services available.

Concierge Service

We can help enhance your stay and help create bespoke experiences from suggesting places to go, where to eat and booking transportation or theatre tickets. No request is too small.

Same-Day Laundry

If travel has taken its toll on your clothes, take advantage of our sameday laundry and dry-cleaning service.



Meetings And Events

DoubleTree by Hilton™ London – West End is an impressive venue for any business event or social gathering. With many versatile booking options and a range of packages, you can be assured your event will be successful each and every time.

- Purpose-built conference centre
- 7 state-of-the-art, flexible meeting rooms for up to 130 delegates
- Natural daylight in some of our ground floor rooms
- Complimentary high-speed WiFi
- Fully air-conditioned
- Adjustable lighting facility
- The latest audio-visual equipment and communications technology
- Dedicated Operations Manager

Eat And Drink

No matter what you're hungry for, you'll find we always have something fresh, tasty and healthy on the menu.

The Level Restaurant

Serving the famous 'Wake up' DoubleTree breakfast and available for private dining.

Restaurant92

Open for lunch and dinner, the restaurant offers an extensive à la carte menu. This cosy yet modern restaurant is perfect for pre-theatre meals, afternoon tea, or socialising with friends.

- In-room dining available 24hrs

Bar92

Ideal for a light snack, Starbucks coffee or a refreshing glass of wine. Experience the relaxed atmosphere, free WiFi and friendly service.

- Open from 7.00am



Out And About

- Covent Garden - 0.7 miles
- Leicester Square - 0.9 miles
- Oxford Street - 0.9 miles
- Piccadilly Circus - 1.0 miles
- St Pauls Cathedral - 1.3 miles
- London Eye - 1.4 miles
- Houses of Parliament - 1.6 miles

Location

Our hotel is ideally located in London's historic Bloomsbury district, between Holborn and Russell Square Underground Stations. With great transport links, easily accessible by tube, rail and bus, you are never too far from where you want to be in London. Just a stone's throw from the British Museum and within walking distance to top attractions such as Covent Garden, the West End and the shops of Oxford Street.

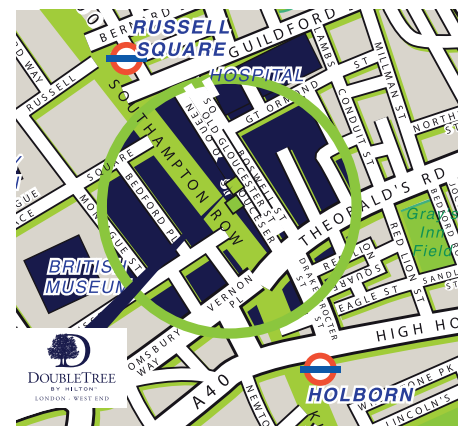

DoubleTree by Hilton
London - West End

Southampton Row,
London, WC1B 4BH
T: +44 (0) 20 7242 2828
F: +44 (0) 20 7831 9170
E: meetings@dtlondonwestend.com
www.dtlondonwestend.com

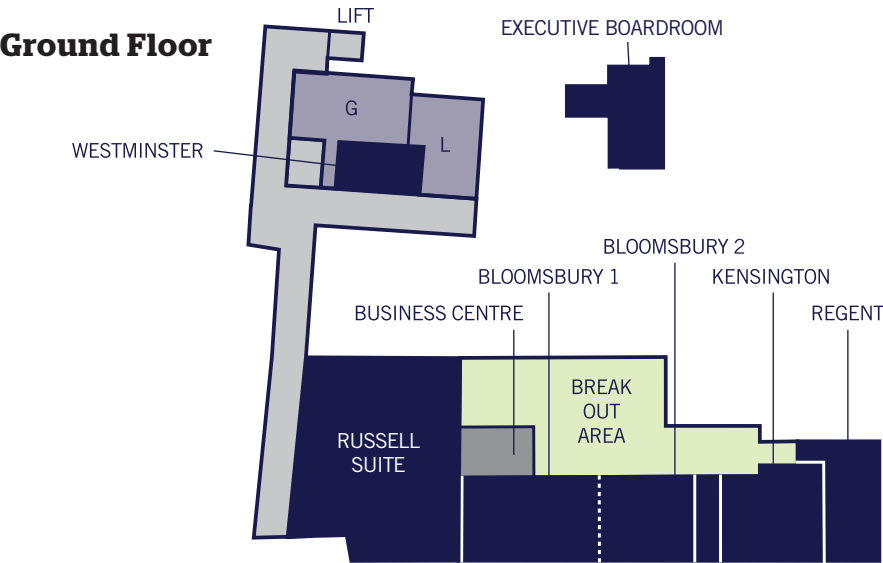

NAME	AREA (Sq M)	THEATRE	BOARDROOM	CLASSROOM	CABARET	U-SHAPE	HOLLOW SQUARE	DINNER DANCE	DINNER	INFORMAL
GROUND FLOOR										
Russell Suite	98	130	34	52	56	32	32	50	80	100
Bloomsbury Suite	88	80	44	46	48	44	48	40	50	60
Bloomsbury 1	48	50	25	25	24	25	28	-	30	50
Bloomsbury 2	40	35	20	20	20	22	24	-	24	40
Kensington Suite	35	25	20	15	20	18	20	-	20	40
Regent Suite	26	20	10	8	8	-	-	-	10	-
Westminster Suite	15	12	8	-	-	-	-	-	8	-
Executive Boardroom	-	15	10	8	8	-	-	-	10	20