



## REWARDS

Join Le Club Accor Hotels Meeting Planner enabling you to earn points with every event; a simple programme adapted to your needs.

## COMMITMENT TO QUALITY

We are committed to quality at Mercure. From industry research and listening to what our customers say, we have developed an understanding of what both meeting planners and delegates truly demand from their meetings. This has helped us draw up our meeting promises.

Ask one of our team members for further details.



## A WARM WELCOME AWAITS

At the Mercure London - Heathrow Hotel, we pride ourselves on the level of service and commitment we offer to all our guests. Our hotel has a unique personality that is enhanced by its enthusiastic team, always offering a warm welcome.

### ACCOMMODATION

The hotel's 184 bedrooms has been designed with a contemporary look and feel, yet comfortable and inviting for guests. Choose from Standard, Superior or Privilege Rooms, all featuring air-conditioning, flat-screen television with satellite channels, mini fridge, laptop safe, en-suite with Grohe bath/rain shower and complimentary toiletries. A dry-gym is free to use for our in-house guests.

### DINING

#### Borders Restaurant

Offers a versatile dining choice for formal or informal dining. The focus is on delivering a contemporary menu with emphasis on fresh and seasonal produce.

#### Borders Bar and Lounge

Showcasing local and international favourites, offering exceptional quality wines and beers at an affordable price. An extensive lounge menu is available all day until 11pm. Complimentary WiFi is accessible throughout.

#### Room Service

24 hour room service available.

### MEETINGS

- 6 multi-purpose meeting rooms for up to 200 delegates
- Natural daylight
- Blackout facilities
- Complimentary WiFi
- All rooms fully air-conditioned
- Audio-visual equipment available to hire
- Food and beverage options
- A dedicated Meetings Co-ordinator
- Business Centre
- The Mercure Quality Guarantee to assure each meeting holds the same quality as the next







### LOCATION

The hotel is close to London's major motorway networks, M4 and M25 plus the A4, making it ideal for business travellers.

Stockley Business Park is close-by, only taking a few minutes by car. London Heathrow Airport is only 2 miles and there is a direct shuttle bus from the hotel to Terminals 2 and 3. With Heathrow Express fast service, you can be in central London in 15 minutes.





	 Theatre Style	 Classroom	 Boardroom	 U-Shape	 Dinner	 Dinner Dance	 Reception
Thames Suite	160	84	60	50	180	160	200
Thames Suite 1	48	24	24	20	40	N/A	48
Thames Suite 2	48	24	24	20	40	N/A	48
Thames Suite 3	48	24	24	20	40	N/A	48
Marlow Suite	40	24	18	15	30	N/A	35
The Boardroom	N/A	N/A	8	N/A	N/A	N/A	N/A
Lounge	70	36	36	26	60	N/A	70

### GROUND FLOOR FUNCTION ROOM

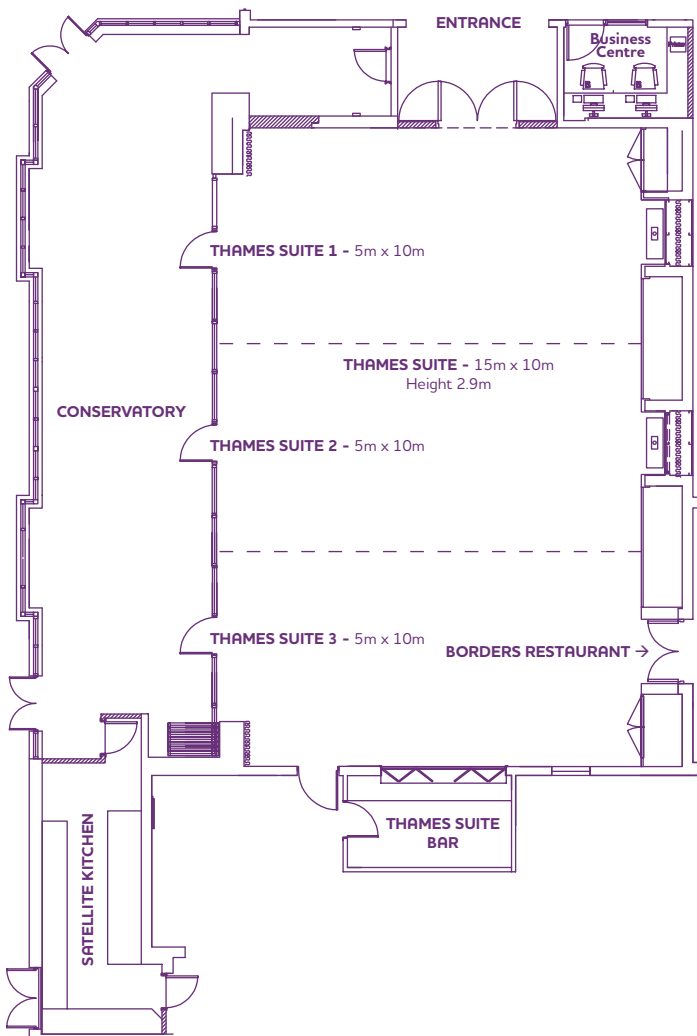

### GROUND FLOOR MEETING ROOM

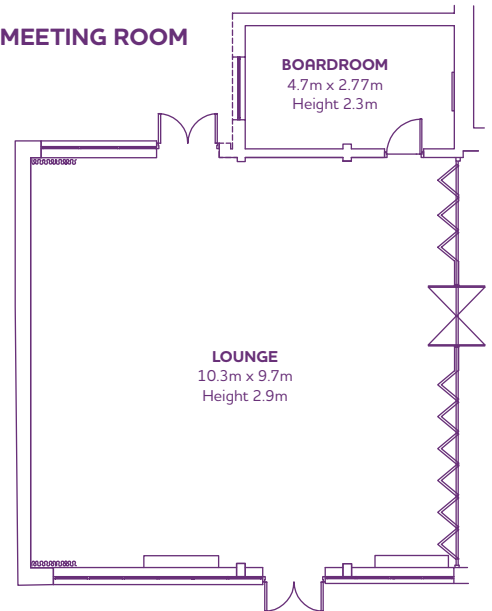

### FIRST FLOOR MEETING ROOM

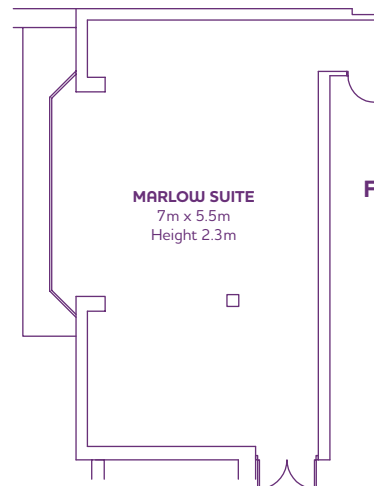

## MERCURE LONDON - HEATHROW HOTEL

Shepiston Lane, Hayes, London UB3 1LP

T: 020 8573 6162 | F: 020 8848 1057 | E: [meetings@mercureheathrow.com](mailto:meetings@mercureheathrow.com)

W: [mercureheathrow.com](http://mercureheathrow.com)